





Adam Hayes - North Finchley Office - Lettings 365 Ballards Lane, North Finchley, London, N12 8LL

Tel: 020 8445 4008 Email: info@adam-hayes.co.uk Web: www.adam-hayes.co.uk

Colney Hatch Lane, London, N11 3DH

£1,700 PCM

 2 Bedrooms  1 Bathrooms  1 Receptions

Key Features

- Two Bedroom Maisonette
- Ground Floor
- 14ft Lounge
- Modern Kitchen
- Private Garden
- Double Glazing
- Garage

Other Information

Council Tax Band: C
Length of Tenancy: Long Let
Deposit: £1,960

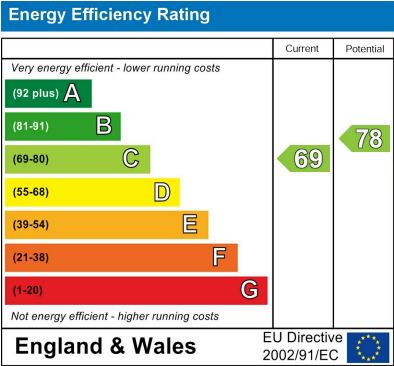

Nearest Stations

- New Southgate Rail

Property Description

This charming two-bedroom ground floor maisonette offers a wonderful blend of comfort and convenience, complete with a private garden and garage. Situated within easy reach of local amenities, the A406, and New Southgate Rail Station, it provides excellent connectivity while maintaining a peaceful setting. The property features a modern fitted kitchen and a spacious 14ft lounge, creating an inviting space for both relaxation and entertaining. With elegant wooden flooring, gas central heating, and double glazing, the home is designed for both style and practicality. Residents will also enjoy easy access to nearby parks and transport links, making it an ideal choice for those seeking a well-connected yet comfortable living space. Early viewings are highly recommended.

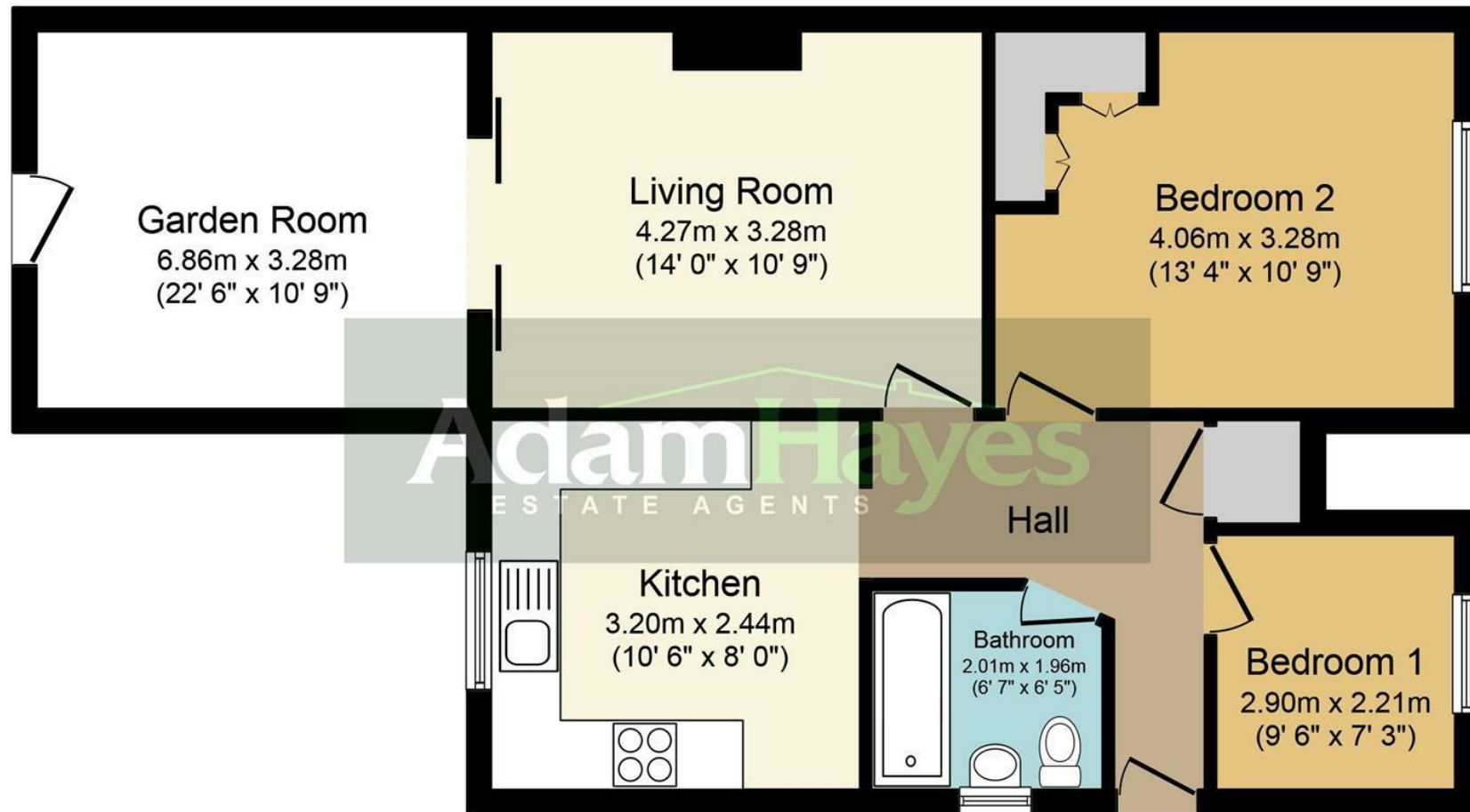

Floor Plan

Total floor area 67.0 sq. m. (721 sq. ft.) approx

This plan is for illustration purposes only and may not be representative of the property. Plan not to scale.

These particulars, whilst believed to be accurate, are set out as a general outline only for guidance and do not constitute any part of an offer or contract. Intending purchasers or prospective tenants should not rely on them as statements or representation of fact, but must satisfy themselves by inspection or otherwise as to their accuracy. We have not carried out a detailed survey, not tested the services, appliances and specific fittings. Room sizes should not be relied upon for carpets and furnishings. The measurements given are approximate. No person in this firm's employment has the authority to make or give any representation or warranty in respect of the property.